

Mass Notification Warning System

Whelen's All-Hazard WPS4004 Series High-Power Voice and Siren Systems deliver clear, powerful voice and siren communication.

SYSTEM FEATURES

- **WPS4004** - Speaker with Four Speaker Cells Active
- Two Compartment (Type II) Natural Finish Aluminum Cabinet
- 129dBc @ 100'
- WPS4004 Speaker Includes Four High Efficiency 400 Watt Speaker Drivers
- 50' cable Included
- Pole Top Mounting Bracket Included
- Public Address Capability
- Battery Powered, Minimum of 30 Minutes of Full Power Output with Batteries of Our Recommendation
- AC Temperature Compensated 10 Amp Battery Charger
- Local Controls or Remote Controls
- Four Power Amplifiers
- Electronic Siren Controller
- Tone Generator
- Timer
- Local Control Push Buttons
- Battery Switch
- SI TEST®
- Battery Tray
- Lightning Arrestor
- Six Standard Public Warning Tones - Wail, Whoop, Attack, Hi-Lo, Alert, Airhorn

SYSTEM OPTIONS

- **SBC280** - Solar Power ¹
- **WPSBATT** - Delco S2000 or Interstate Workaholic 31-MHD Batteries
- **WPSNCMIC** - Noise Cancelling Microphone
- Alternate Tone Set
- **RDVM** - Digital Voice Message Capability ²

NOTES:

- 1 Solar power option includes 2 - 80 watt panels, mounting bracket and regulator
- 2 **RDVM** - 1-16 message capability with 240, 480 or 960 seconds available for recording

SIREN ACTIVATION CONTROLS

Our VHF High and UHF siren activation control packages include the following:

- Radio
- Radio Interface
- Tone Squelch
- 2-3dB Gain Omni-Directional Antenna with Bracket
- 35' of RG58 Antenna Cable
- Polyphaser
- SI TEST®
- Low Battery Alarm (Two-Way only)

Other features are dependant upon one or two-way controls. Whelen equipment can be interfaced with many different types of two-way radio communications products and systems including 800Mhz trunking, Motorola's MOSCAD, FSK, Narrow-Band and VHF Low Band. The following is available as standard options. Contact factory for special applications.

ONE WAY CONTROLS

- **AUXIN** - Auxiliary Board for Contact Closure Activation
- **D2020LL** - 10 Digit DTMF Landline Activation
- **D2020H** - 10 Digit DTMF VHF High Band / 150-170 Mhz
- **D2020U** - 10 Digit DTMF UHF / 450-470 Mhz
- **WPSTT** - Two-Tone Sequential Option

TWO-WAY CONTROLS

- **AUXCS** - Two-Way Contact Closure Activation and Status Board
- **C2020LL** - Two-Way Landline Activation
- **C2020H** - 10 Digit DTMF VHF High Band / 150-170 Mhz
- **C2020U** - 10 Digit DTMF UHF / 450-470 Mhz
- **C2020NH** - 10 Digit DTMF VHF High Band Narrow-Band
- **C2020NU** - 10 Digit DTMF UHF Narrow-Band

Options:

- **FSKXMOD** - Converts the Above Siren Activation Controls to FSK Format
- **STATUS** - Cabinet Window LED Status Indicator
- **PGINT** - Paging Interface to Interface Whelen Tones with Existing Paging Systems
- **INTRU** - Intrusion Alarm (available with Two-Way only)

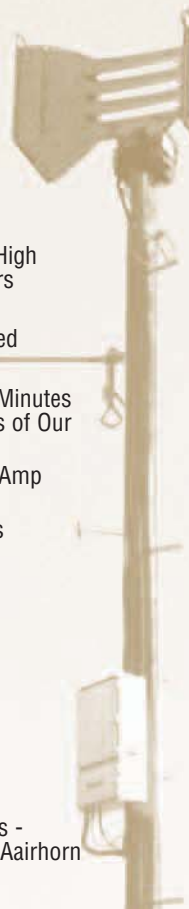

TYPE II
ELECTRONIC
CABINET

WHELEN®

WPS4004

Specification Data

Component	Height Inches (CM)	Width Inches (CM)	Depth Inches (CM)	Weight Lbs. (KG)
WPS4004 SPEAKER	52.5 (133.3) ^②	31.6 (80.1)	56.0 (142.2)	281 (127.5)
ELECTRONICS CABINET TYPE II [Ⓞ]	40.7 (103)	30.0 (76)	10.0 (25.4)	140 (63.5)
POLE TOP BRACKET	30.5 (77)	12.0 (30.5)	10.0 (25.4)	71 (32)

① A 6.00" wide mounting channel adds 3.50" in height and 2.00" in depth.
② Height with rotor.

WHELEN[®]
ENGINEERING COMPANY, INC.

Route 145, Winthrop Road
Chester, Connecticut 06412-0684
(860) 526-9504
1-800-637-4736
Fax: (860) 526-4784
Internet: www.whelen.com
e-mail: iowasales@whelen.com

Whelen Engineering Company, Inc. reserves the right to upgrade its products with design improvements without notification.
© 2005 Whelen Engineering Company, Inc.
Printed in the U.S.A.
070105-10566F

ELECTRICAL

- **Battery charger input:** 120VAC, 60Hz, 7A Fuse (240 VAC 50/60 Hz available)
- **Battery charger output:** 28VDC, 10A (NOMINAL)
- **Batteries:** (2) 12V, 115AH Lead Calcium
- **Standby current:** 135mA, 24VDC
- **Operating current:** 89A, 24VDC
- **Power amplifier output power:** siren: 1600 Watts
voice: 2000 Watts

ENVIRONMENTAL

- **Operating temperature:** -35°C to +60°C
- **Storage temperature:** -65°C to +125°C
- **Humidity, non condensing:** 0 to 95%

ORDERING INFORMATION

BASIC SYSTEM INCLUDES ALL OF THE FOLLOWING:

- **WPS4004** - Speaker Assembly & Electronics Cabinet

OPTIONS:

- **RDVM** - Remote Station Digital Voice¹
- **AUXIN** - Auxiliary Board for Contact Closure Activation
- **AUXCS** - Auxiliary / Status Control Board for Contact Closure Activation and Status
- **D2020LL, D2020H, D2020U** - One-Way Radio Control²
- **C2020LL, C2020H, C2020U** - Two-Way Radio Control / Status Monitoring, COMM/STAT²
- **C2020NH, C2020NU** - Two-Way Narrow-Band Radio Control / Status Monitoring, COMM/STAT⁴
- **WPSTT** - Two-Tone Sequential
- **FSKXMOD** - FSK Format
- **STATUS** - Cabinet Window LED Status Indicator
- **PGINT** - Paging Interface to Interface Whelen Tones with Existing Paging Systems
- **INTRU** - Intrusion Alarm
- **SBC280** - Solar Power³
- **WPSBATT** - One Pair of Batteries

NOTES

- RDVM** - 1-16 message capability with 240, 480 or 960 seconds available for recording
- 10 digit DTMF Controls • Landline • VHF High Band/150-170 Mhz • UHF/450-470 Mhz
Our VHF High and UHF siren activation control packages include tone squelch, radio, radio interface, 2-3dB gain omni-directional antenna with bracket, 35' of RG58 antenna cable and polyphaser
- Solar power option includes 2 - 80 watt panels, mounting bracket and regulator
- Contact Factory

Acoustic Performance

SPL @ 100': 129dB

Estimated 70dB range: 6,000'

Estimated 60dB range: 12,000'

Note: 100' performance levels listed represent repeatable results within +/-2dB to stated levels.
Estimated 70dB perimeter is based on the Federal Emergency Management Agency's (FEMA) -10dB per distance doubled path model.

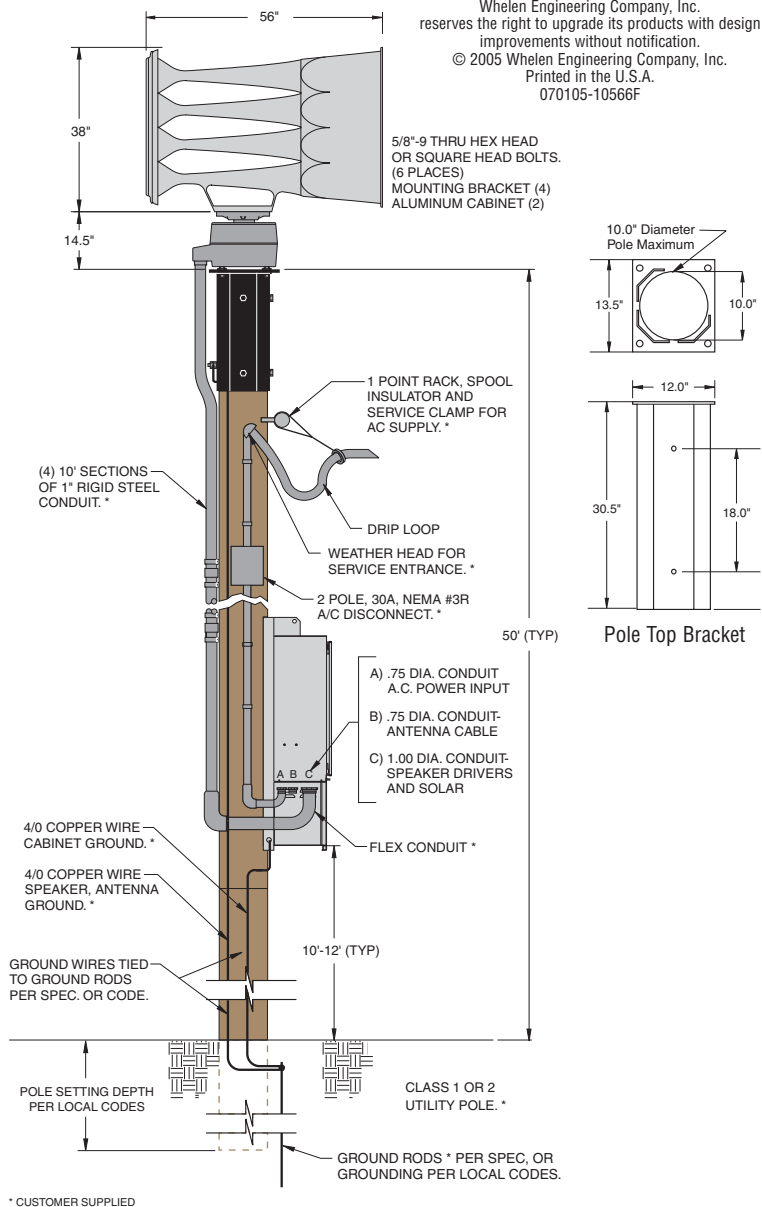
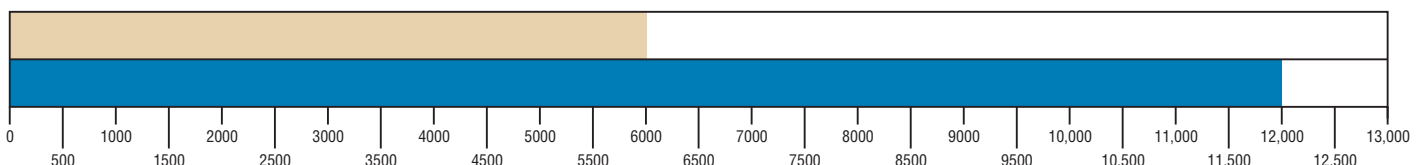

* CUSTOMER SUPPLIED